

CRX32-s1

*shown with Freeline Hi-Tech aluminum steering shaft.

birel



birel

2009. The CRX32-s1 is an all 32mm chassis that has proven to provide excellent mechanical grip using a wide range of tire compounds. The CRX32 has been revised for 2009 with minor changes to improve balance and consistency while also adding many standard features such as the all-new 25mm front spindle design and bonus features like the Hi-Tech billet aluminum heel-stop. Take a closer look at the new CRX32-s1 at your nearest MRP/Birel dealer or online at www.GoBirel.com.

CRX32 - s1

Shifterkart

Standard Equipment :

- Dual front torsion bars
- Reinforced spindle yokes for safety & durability
- 32mm chassis construction
- Adjustable front & rear ride-height
- Freeline "CX" brake system w/ cast-iron rotors
- Freeline spherical castor/camber adjusters
- Genuine Freeline magnesium wheels
- Removable 4th frame rail
- 50mm Freeline axle (40mm optional)
- Freeline CIK09 bodywork
- Birel Motorsport graphics kit
- Optional rear torsion bar
- Freeline exhaust pipe mounts

For full chassis specifications, visit:

GObirel.com
A Division of MRP Motorsport

For more information:

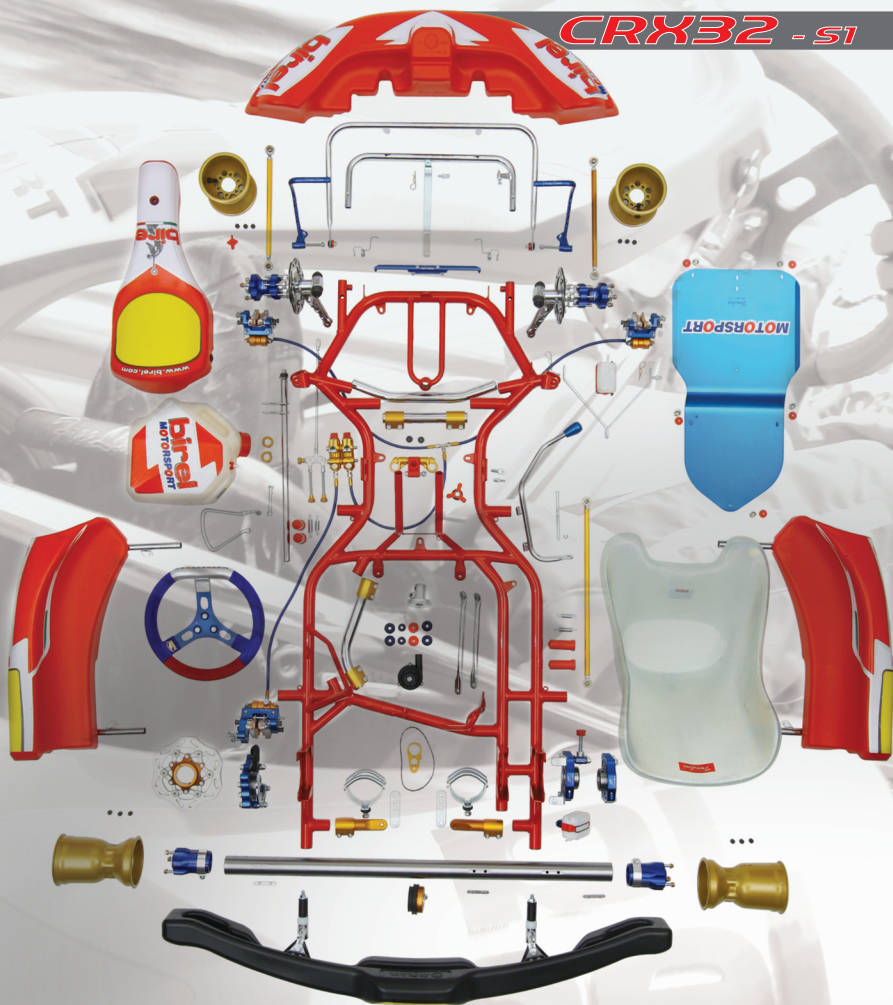

North American Importer for World Champion **birel** & **Freeline** products.

© 2009 MRP Motorsport & www.GoBirel.com. All Rights Reserved. Birel & Freeline are trademarks of Birel SpA.

*Birel MTS accessory package includes aluminum anodized components, Freeline magnesium wheels & "Motorsport" steering wheel.

birel

**FREELINE
ADJUSTABLE
HI-TECH HUBS**

**ADJUSTABLE
BRAKE BIAS**

**ADJUSTABLE
PIPE MOUNTS**

**ADJUSTABLE
HEEL-STOP**

**MAGNESIUM
WHEELS**

**REMOVABLE
4TH RAIL**

**FLOATING
ROTORS**

2009 CRY31-s1 & DD2. For drivers looking for a proven chassis with a wide range of adjustments, look no further than the Birel line of shifterkart chassis. The 2009 CRY31-s1 includes all of the updates of the RY31-s1 model and more with the addition of floating cast-iron front rotors surrounded by Freeline "CX" series calipers all mounted on the new 25mm spindles. The CRY31-s1 is also available in a Rotax Max DD2 model as well, providing you with both function and performance in Rotax's shifterkart class. Get a new Birel shifterkart chassis from your nearest MRP/Birel dealer.

CRY31 - s1

Shifterkart

DD2 - CRY31

Rotax Max DD2

Standard Equipment :

- Dual front torsion bars
- Reinforced spindle yokes for safety & durability
- 32mm/30mm chassis construction
- Adjustable front & rear ride-height
- Freeline "CX" brake system w/ cast-iron rotors
- Freeline spherical castor/camber adjusters
- Genuine Freeline magnesium wheels
- Removable 4th frame rail
- 50mm Freeline axle (40mm optional)
- Freeline CIK09 bodywork
- Birel Motorsport graphics kit
- Optional rear torsion bar
- Freeline exhaust pipe mounts

Standard Equipment :

- Dual front torsion bars
- Reinforced spindle yokes for safety & durability
- 32mm/30mm chassis construction
- Adjustable front ride-height
- Freeline "CX" brake system w/ cast-iron rotors
- Freeline spherical castor/camber adjusters
- Genuine Freeline magnesium wheels
- Removable 4th frame rail
- 40mm Freeline axle
- Freeline CIK09 bodywork
- Birel Motorsport graphics kit
- Available Rotax DD2 engine package

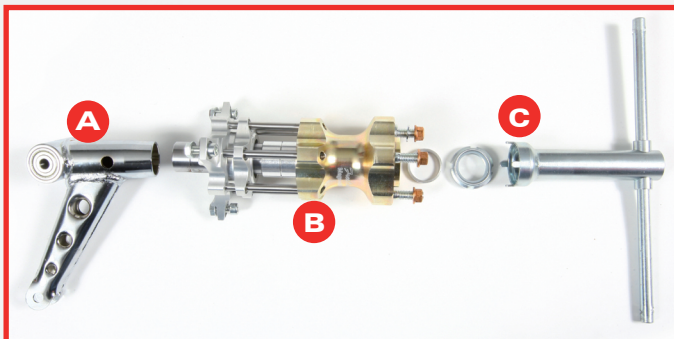

Birel's all-new 25mm interchangeable hub system provides the widest range of front-end adjustment in the karting world.

- A. Interchangeable stub-axle. (soft, medium and hard stub axles available)
- B. Adjustable width using Freeline's hub and slider system. (shown with magnesium hub)
- C. 25mm spindle nut and tool comes standard with all 2009 models.

For full chassis specifications, visit:

GoBirel.com
A Division of MRP Motorsport

For more information:

North American Importer for World Champion **birel** & **Freeline** products.

© 2009 MRP Motorsport & www.GoBirel.com. All Rights Reserved. Birel & Freeline are trademarks of Birel SpA.

*Birel MTS accessory package includes aluminum anodized components, Freeline magnesium wheels & "Motorsport" steering wheel.